

# Installation Instructions

Curved & Square Under Basin Furniture

# VESSINI

# VESSINI

## Installation Instructions

### Important - Please Read

Please read these instructions carefully before starting installation and keep for future reference. Remove all packaging and check the product for missing parts or damage before starting installation; we cannot accept any liability for deficit / refit costs where a damaged or faulty product has been fitted. In addition we do not accept responsibility for any problems that arise through incorrect installation or modification of the product.

Due to our commitment to continuous product development we reserve the right to alter specifications without notice. Products are guaranteed against manufacturing defects for the first purchaser only and the guarantee is non-transferable. Our liability under any guarantee expressed or implied is strictly limited to replacement of defective goods or a refund at our discretion and no consequential losses will be entertained. Proof of purchase will be required.

### General Installation

This product should only be installed by a suitably qualified installer.

When drilling or fixing into walls or floor it is essential that you check for pipes or wires before commencing. These instructions are based on installation to a blockwork wall; if you are installing on to plasterboard / stud walling please use the appropriate fixings and ensure that the wall is able to fully support the weight of the product.

### Product Care

Our products are finished to the highest standard and due care needs to be taken to ensure their looks are retained. We recommend cleaning all products with a soft damp cloth **ONLY** and advise strongly against the use of **ALL** cleaning products i.e. powders and liquids. If the above instructions are not followed this will invalidate your guarantee in the event of a problem occurring.

### Parts Supplied

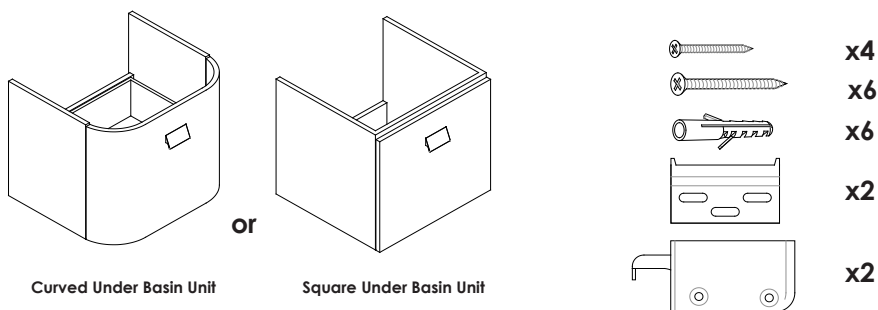

### Tools Required (Not Supplied)

Drill, 8mm Suitable Drill Bit, Phillips Screwdriver, Pencil, Level & Tape Measure.

## Installation

**Note: Vessini Under Basin Furniture has not been designed to carry the weight of the basin above. Please ensure that the basin is adequately fixed using basin fixing bolts prior to installation of the under basin furniture.**

Using a pencil & level, mark a line 80mm beneath the underside of your basin, then mark a central vertical line following the centre of your basin to ensure even spacing to either side. Use either Fig. 1 or 2 according to your choice of unit to find and mark the location for the wall fixing brackets. Mark a hole centrally at each three fixing points on either bracket (this will allow for any adjustment) then drill 8mm dia holes using a suitable drill. Insert a plug into each hole then fix the wall brackets in place using 6 No. 40mm screws supplied. The edges of the brackets should just touch the inside edges of the basin furniture; if this is not the case, loosen the screw fixings slightly and re-adjust before then re-tightening the screw fixings. Do not overtighten.

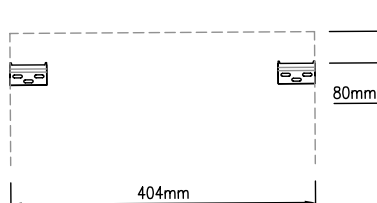

Fig. 1 - Square Under Basin Wall Bracket Set Out Detail

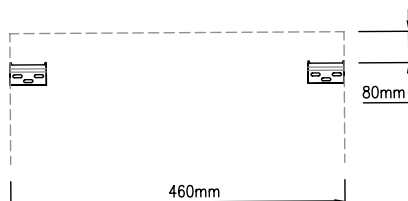

Fig. 2 - Curved Under Basin Wall Bracket Set Out Detail

Mark out the location of the two adjustable furniture brackets with a pencil to the dimensions noted in Fig. 3, then fix to the inside of the basin furniture using 4 No. screw fixings supplied. Do not overtighten.  
TIP: The two brackets are marked 'L' and 'R' to signify which side they should be located against.

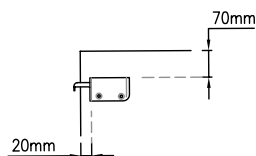

Fig. 3 - Set Out Detail for Furniture Brackets

NOTE: The brackets have bolt fixings on the base and rear to allow fine adjustment. These will allow you release / pull the unit to the wall and also to raise or lower the unit to the basin above (see Fig. 4).

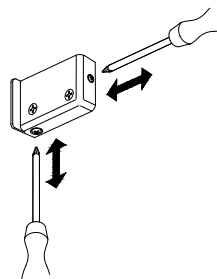

Fig. 4 - Fine Adjustment Achievable

## Guarantee

This product is guaranteed against manufacturing defects from the date of purchase until the expiry of the relevant guarantee period shown below.

### The guarantee is only valid if:-

1. The product has been installed, used and maintained in accordance with Vessini's instructions and subjected to normal use only,
2. The defect is not due to use of an unsuitable or inadequate water supply.
3. The defect is not due to accident, misuse, neglect or repair other than by Vessini or Vessini authorised agents or damage caused by foreign objects or substances.

Under this guarantee (which is non-transferable) Vessini will, at its option, repair or replace free of charge any product (or replacement part) found to be defective. The guarantee does not extend to any consequential loss or damage. After repair or replacement the relevant guarantee period will be calculated from the original date of purchase.

This product is subject to a twelve year guarantee.

All claims under the guarantee must be submitted in writing to the person who supplied the product to you and must be received no later than the last day of the relevant guarantee period. All claims must be accompanied by proof of purchase (sales receipt or delivery note).

Vessini operates a policy of continuous product development and therefore reserves the right to change the product, packaging and documentation specifications without notice.

This guarantee is in addition to and does not affect your statutory rights as a consumer.

## Customer / Technical Services

For any technical or installation queries please contact Abacus Direct on 0871 222 05 44.

Due to our commitment to continuous product development we reserve the right to alter specifications without notice. Products are guaranteed against manufacturing defects for the first purchaser only and the guarantee is non-transferable. Our liability under any guarantee expressed or implied is strictly limited to replacement of defective goods or a refund at our discretion and no consequential losses will be entertained. Proof of purchase will be required.